

Cruise Control

Main Switch Test

CAUTION:

- All SRS wiring harnesses are covered with yellow outer insulation.
- Before disconnecting any part of the SRS wire harness, install the short connectors (see page 23-407).
- Replace the entire affected SRS harness assembly if it has an open circuit or damaged wiring.

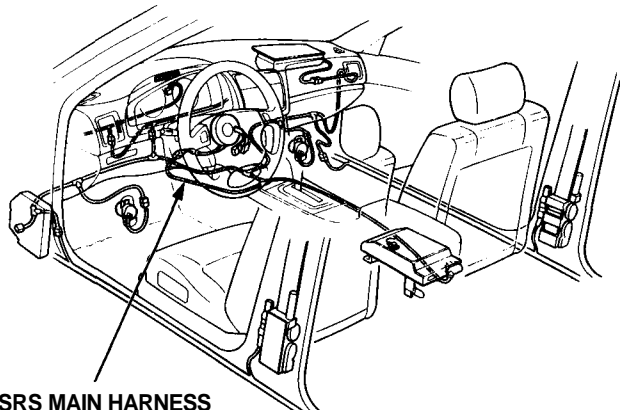

SRS MAIN HARNESS
(Covered with yellow outer insulation)

1. Remove the instrument panel, then remove the cruise main switch from the instrument panel.

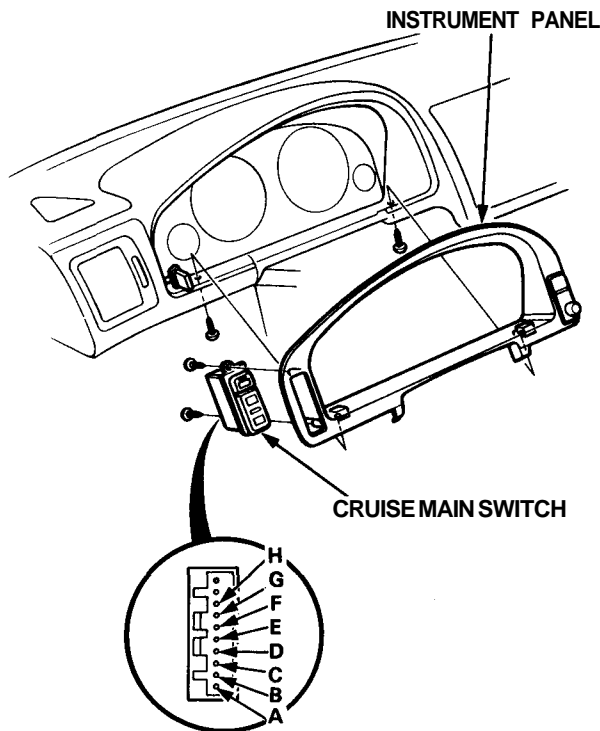

2. Check for continuity between the terminals in each switch position, according to the table. If continuity does not match the table, replace the switch.

Terminal Position	A		B	C	D		E
OFF	○	⊗	○			○	⊗
ON	○	⊗	○	○		○	○

